

# GENUINE DOOR SWITCH PANEL

## Using (Installation) Instructions

Applicable model: MX-5  
Part Number : NE52 V1 200F (Wood tone)  
NE55 V1 200F (Aluminum tone)  
NE58 V1 200F (Piano black tone)  
QNCC V1 200 C1 (Carbon tone)

Thank you very much for buying the Mazda Genuine Parts.

Before removal and installation, you are expected to carefully read these instructions.

To use it in its best conditions, be sure to read thoroughly read these instructions for full Understanding of the contents and to properly use it.

### < Cautions and Requests >

● ⚠ CAUTION and ⚠ WARNING marks shown in these instructions indicate safely precautions, which you are requested to strictly comply with during installation and use.

⚠ WARNING : Indicates a situation in which serious injury or death could result if the warning is Ignored.

⚠ CAUTION : Indicates a situation in which bodily injury or damage to the vehicle could result in if the caution is ignored.

- Do not install the door switch panel in any way other than described in the following instructions.
- Do not modify the door switch panel.
- To ensure safety and reliability of the work, installation, removal and disposal work must be carried out by an authorized Mazda Dealership.
- If you have any questions about the use of the accessory, ask your Mazda dealer for proper advice before using it.
- We may not accept the liability for any problems that might have occurred due to incompliance with these instructions.
- Be careful not to lose removed parts, and be sure they are kept free from scratches, grease or other dirt.

#### To the dealer

Please turn over these instructions to the customer after installation.

#### To the customer

- Keep these instructions after installation. The instructions may be necessary for installing other optional parts or removal of this accessory.
- Should the vehicle or this accessory be resold, always leave these instructions with it for the next owner.

**Mazda Motor Corporation**

3-1, Shinch, Fuchu-cho, Aki-gun Hiroshima

1

## AS-COMPLETED VIEW

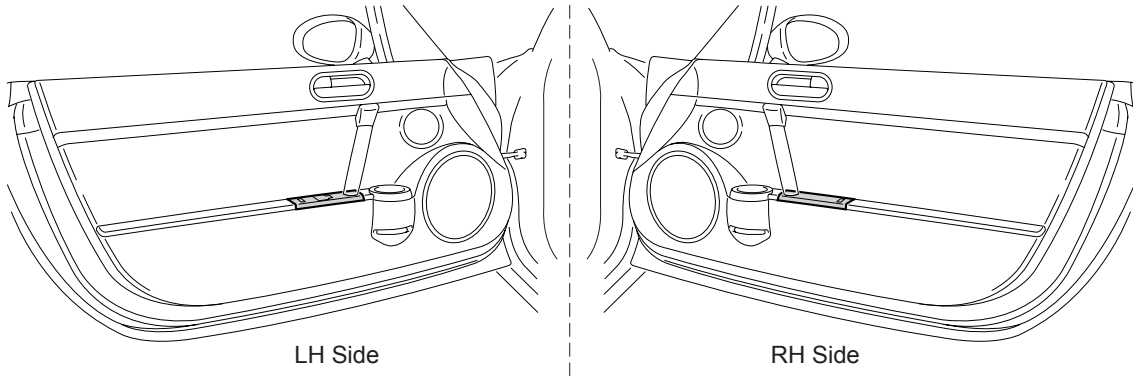

2

## COMPONENTS

### ⚠ CAUTION

Make sure that there is no missing component based on the following parts list and check the components for any dirt, scratches or other damage.

No.	Part name	Q'ty
①	Door switch panel RH	1
②	Door switch panel LH	1
③	Using (installation) instructions	1

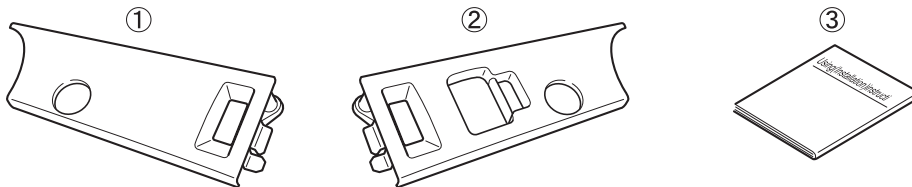





3

## PREPARATORY WORK BEFORE INSTALLATION

**Tools used** (Have them ready at hand before starting the work.)

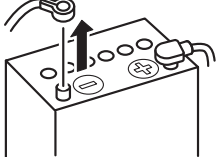
◆Phillips screwdriver ◆Flathead screwdriver ◆Protective tape

### ⚠ CAUTION

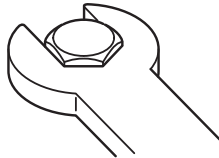
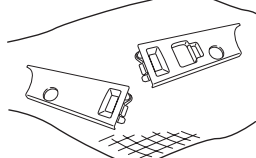
Disconnect the negative terminal of the battery before doing the work.	Hold the connectors when disconnecting / connecting them to ensure the disconnection / connection.	Avoid exercising excessive force when pulling a wiring harness.
		
Use a mat or any other protective material when removing / installing components.	Use right tools appropriate for the purpose and size of the work to be done to ensure proper execution of the work.	Place the removed parts and components on a protective sheet or equivalent to avoid any damage on such parts/components.
		

### Note

- Consult the service manuals for the vehicle for the instructions on the removal and installation of the vehicle components.

# 4

## VEHICLE COMPONENT REMOVAL [R.H. (Passenger's side) and L.H. (Driver's side)]

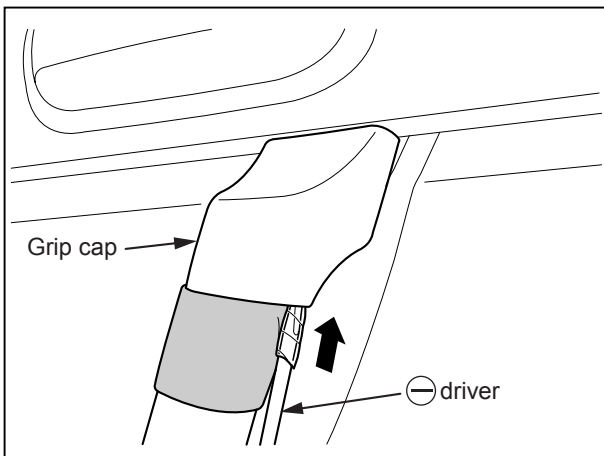
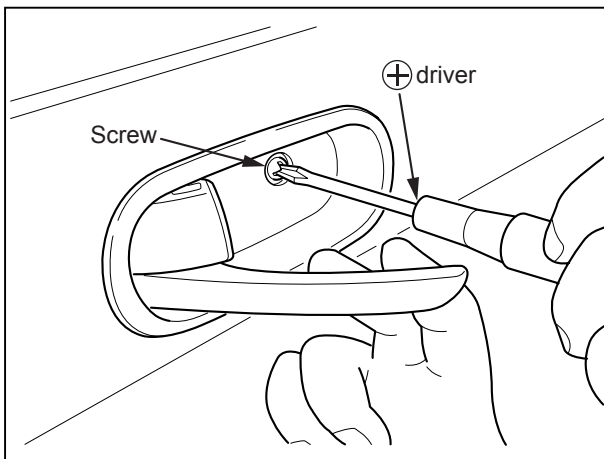
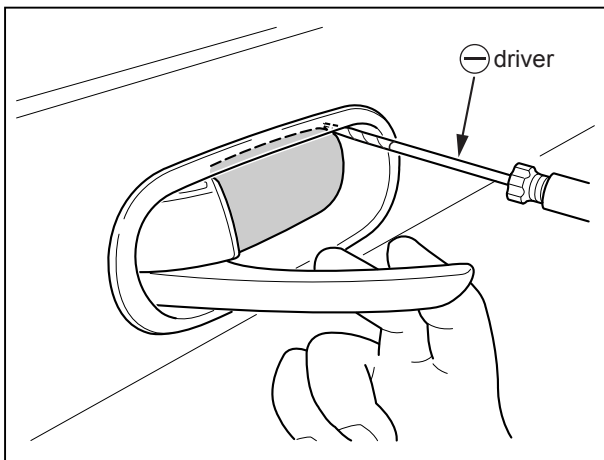
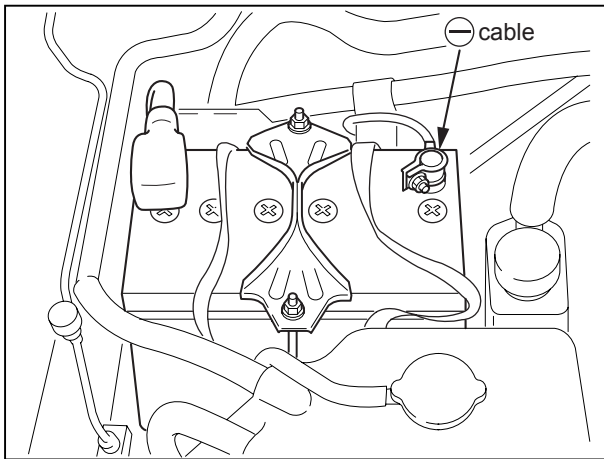

### DOOR SWITCH PANEL REMOVAL

1. Disconnect the negative battery cable by the following procedure.

- ① Check that the power for items such as the headlamps and air conditioner are all turned off, and then remove the battery cover.
- ② Disconnect the negative battery cable.

**CAUTION**

- Never bring naked flames close to the battery when handling the battery, otherwise the gases released by the battery may ignite and cause an explosion.

2. Lift up the inside door handle, wrap the protective tape around the tip of flat-tipped screwdriver, and then insert the flat-tipped screwdriver into the gap between the inside door handle and the cap as shown in the diagram at left, and then pull the door handle forward.

**CAUTION**

- Use a flat-tipped screwdriver with as narrow a tip as possible to avoid damaging the components.

3. Use a Phillips screwdriver to remove the tapping screw that is securing the inside door handle cover.

4. Attach protective tape to the outside of the grip (the  area in the diagram at left) or wind protective tape around the tip of the flat-tipped screwdriver, and then insert the flat-tipped screwdriver as shown in the diagram at left to disengage the grip cap.

**CAUTION**

- Use a flat-tipped screwdriver with as narrow a tip as possible to avoid damaging the components.

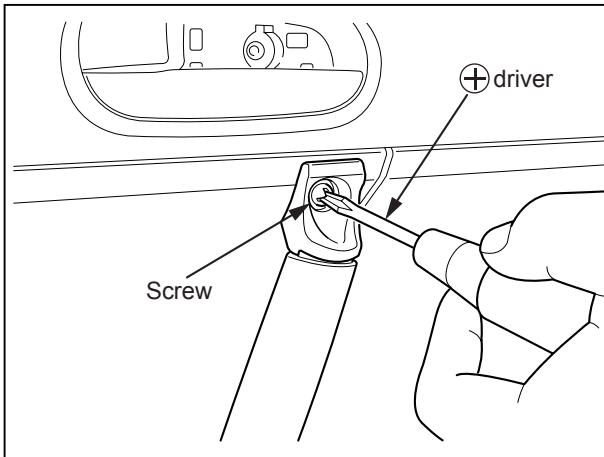

5. Use a Phillips screwdriver to remove the tapping screw that is securing the grip.

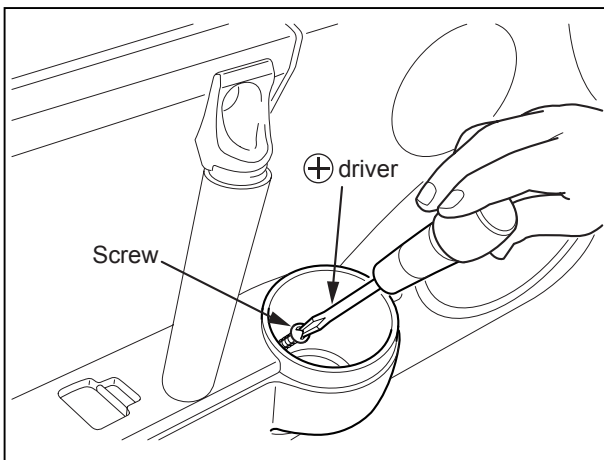

6. Use a Phillips screwdriver to remove the tapping screw that is securing the pocket.

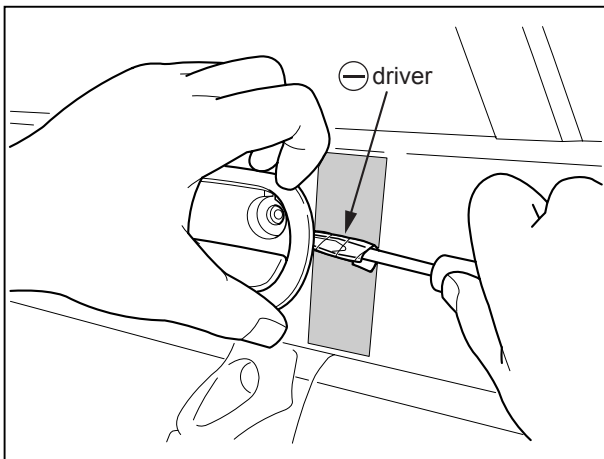

7. Attach protective tape to the end of the inside door handle cover (the  area in the diagram at left) or wind protective tape around the tip of the flat-tipped screwdriver, and then insert the flat-tipped screwdriver into the middle of the inside door handle cover as shown in the diagram at left to disengage the clip.



**CAUTION**

- Use a flat-tipped screwdriver with as narrow a tip as possible to avoid damaging the components.

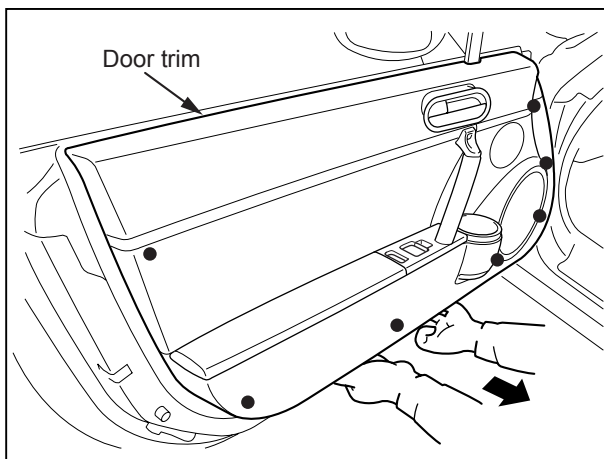

8. Place your fingertips against the bottom of the door trim as shown in the diagram at left, and then pull the bottom of the door trim toward you to remove it. (The marks ※ in the diagram show the locations of fasteners.)

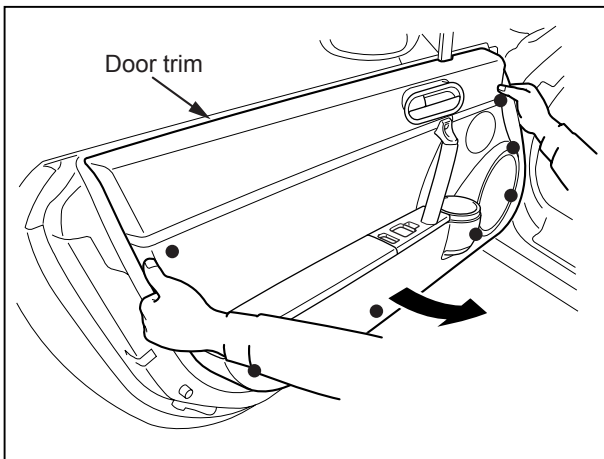

9. Place your fingertips against the front of the door trim as shown in the diagram at left, and then pull the door trim forward to remove it.  
(The marks ※ in the diagram show the locations of fasteners.)

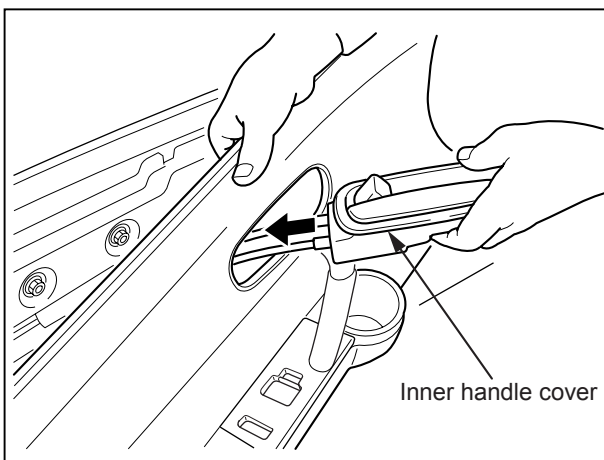

10. Hold the door trim with one hand and separate the inside door handle cover from it in the direction of the arrow.

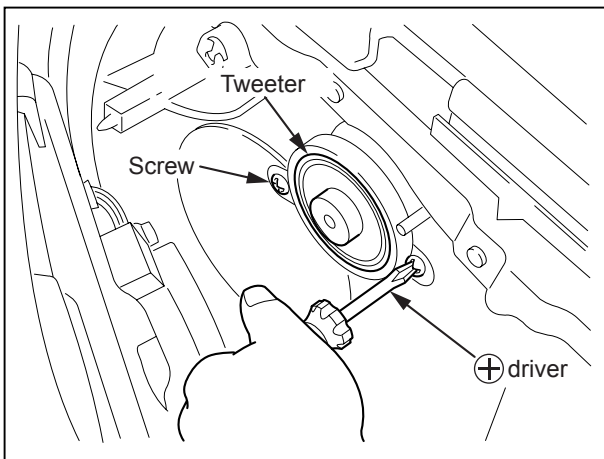

11. Use a Phillips screwdriver to remove the two tapping screws that are securing the tweeter.



### CAUTION

- To prevent the possibility of damage to the tweeter grille, use protective tape or similar to provisionally attach the tweeter grille to the vehicle body until it is time for it to be reinstalled.

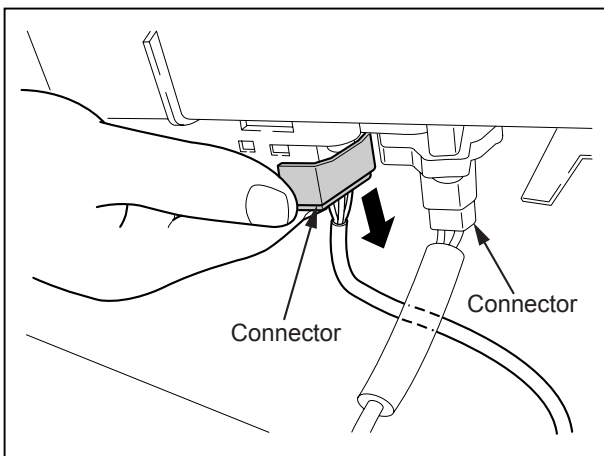

12. Disconnect the connector.  
There are two connectors, at the L.H. (driver's) side and there is one at the R.H. (passenger's) side.

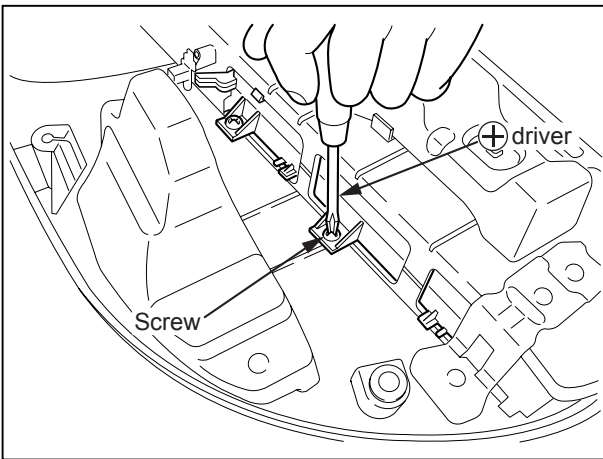

13. Use a Phillips screwdriver to remove the two tapping screws that are securing the arm rest.



### CAUTION

- In order to avoid damaging the arm rest when removing it, push the arm rest up while putting your finger under one arm rest fixing tab at a time to disengage it, and then remove the arm rest.

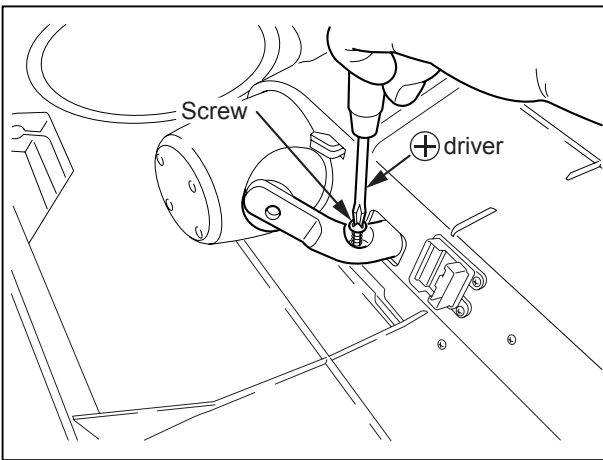

14. Use a Phillips screwdriver to remove the tapping screw that is securing the grip.

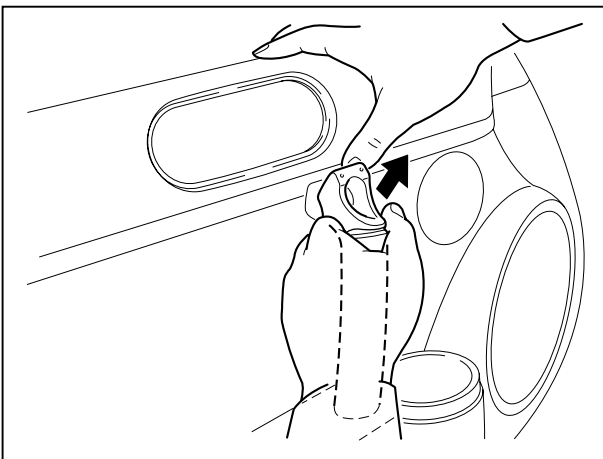

15. Hold the grip and pull it forward to release the top of the grip.

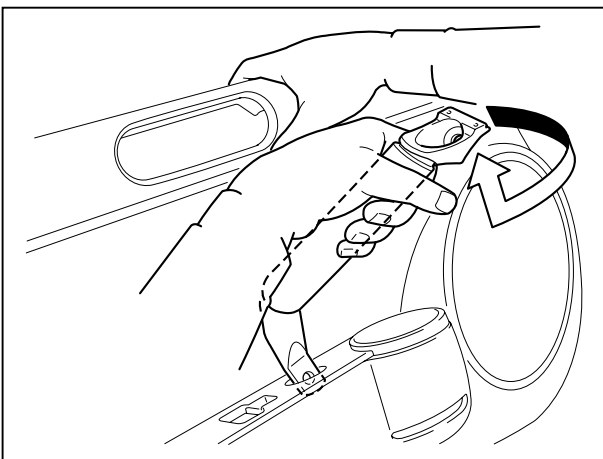

16. Turn the grip in the direction of the arrow while pulling the grip to remove it.

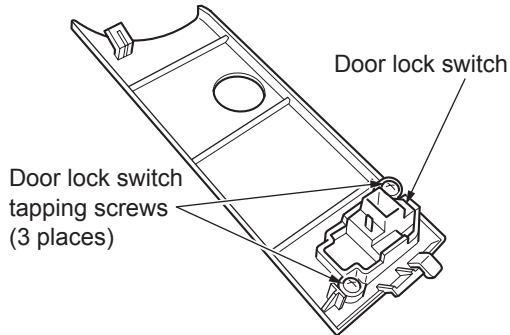
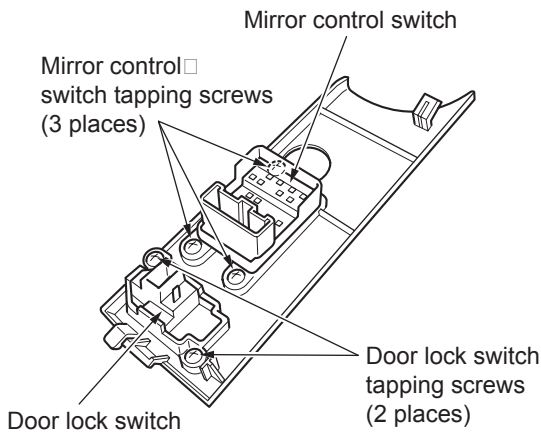
**5****DOOR SWITCH PANEL INSTALLATION [R.H. (Passenger's side) and L.H. (Driver's side)]****R H (Passenger's side)****L H (Driver's side)****MIRROR CONTROL SWITCH REPLACEMENT**

1. Remove the mirror control switch from the door switch panel.
2. Install the mirror control switch to the new door switch panel by carrying out the removal procedure in reverse.

**CAUTION**

- Install the mirror control switch so that the switch knob can still be operated correctly.
- Install the switch tightly, but be careful not to over tighten the tapping screw, otherwise it may damage the mounting area.

**NOTE**

- The old door switch panel is not need for this new product.

**DOOR SWITCH PANEL REPLACEMENT**

1. Install the door switch panel by carrying out the removal procedure in reverse.

**CAUTION**

- Connect the connectors securely.
- Install the panel tightly, but be careful not to overtighten the tapping screw, otherwise it may damage the mounting area.

**— To the customer —**

If the surface of the door switch panel is dirty, wipe it with a clean cloth that is lightly soaked in neutral detergent.

**CAUTION**

- Do not use substances such as gasoline or organic solvents to clean the door switch panel, otherwise it may damage the panel.

**6****VEHICLE COMPONENT REASSEMBLY [R.H. (Passenger's side) and L.H. (Driver's side)]**

1. Attach the door trim to the door panel in the reverse of the procedures for removing components.
2. Connect the negative battery cable.

**CAUTION**

When the battery is disconnected, the DSC will stop operating.  
(The DSC OFF indicator will flash at this time, and the TCS/DSC operation indicator will illuminate.)  
Carry out the following procedure to reactivate DSC.

1. Turn the ignition switch to "ON".
2. Turn the steering wheel clockwise as far as it will go, and then turn it back counterclockwise as far as it will go.
3. Check that the DSC OFF indicator is turned off.
4. Turn the ignition switch to "OFF" and then turn it back to "ON".
5. Check that the TCS/DSC operation indicator is turned off. If the TCS/DSC operation indicator is still illuminated or the DSC indicator is not turned off when the ignition switch is turned back to "ON", contact your Mazda dealer.

3. Install the battery cover by carrying out the removal procedure in reverse.

**CAUTION**

- When installing the engine cover, check that the engine cover is firmly secured.

**CAUTION**

- Check if any of the components are dirty before installing them. If they are dirty, clean them.

4. Please inspect the operation after the work.

**CAUTION**

- If the battery connection is broken, the power windows will no longer fully open or fully close automatically. Carry out the following operation to restore normal operation.
  1. Set the ignition key to the "ON" position.
  2. Press the power window switch to fully open the power windows.
  3. Lift up the power window switch to fully close the power windows, and keep it pulled up for approximately 2 seconds.



# Installation Inspection Sheet

[To be used by installation workshop]

MX-5	DOOR SWITCH PANEL
	NE52 V1 200F (Wood tone) NE55 V1 200F (Aluminum tone) NE58 V1 200F (Piano black tone) QNCC V1 200 C1 (Carbon tone)

## POINTS TO CHECK AFTER INSTALLATION

- Carry out the following inspections on all installed components and removed components once installation is complete.
- Check any crevices and folds by referring to the attached external check list.

Section to be inspected	Inspection item (circle)			
	Gap / fit & finish	Scratch, stain, tape residue	Tightening & engagement	Function
Door switch panel	○	○	○	
Door trim	○	○	○	
Mirror control switch	○	○	○	○
Door lock switch	○	○	○	○
Power window switch	○	○	○	○
Inside door handle				○
DSC				○

### Door switch panel installation inspection

Date		(year/month/day):			
VIN: No.					
Approved		Checked		Prepared	

※ Retention period of the sheet: 3 months